

Preliminary Step 2. Set Up a Google Account:

You must be connected to the internet (WIFI or data plan connection). Refer to Preliminary Step 1 if needed.

If you do not have a Google Account, open your Android Settings menu:



Scroll through the list of Settings, and select **Accounts** (Listed in the “Personal” section)

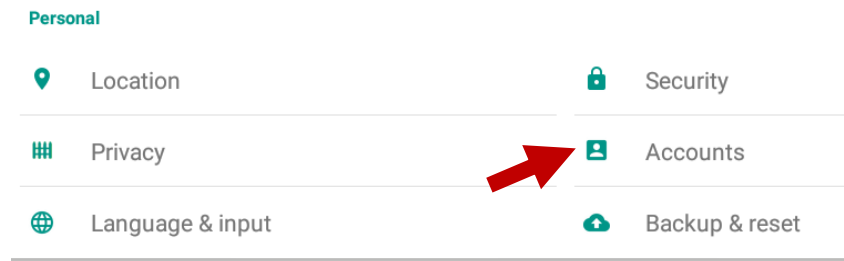

Select: Add Account

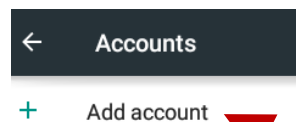

Add a Google Account

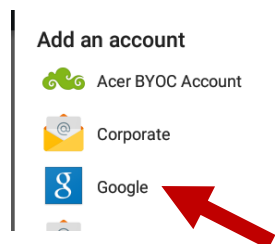

The Android Device will try searching for any existing account info. If you already have a Google Account, enter your email (A). If you do not have any account on the device, select "CREATE A NEW ACCOUNT (B)".

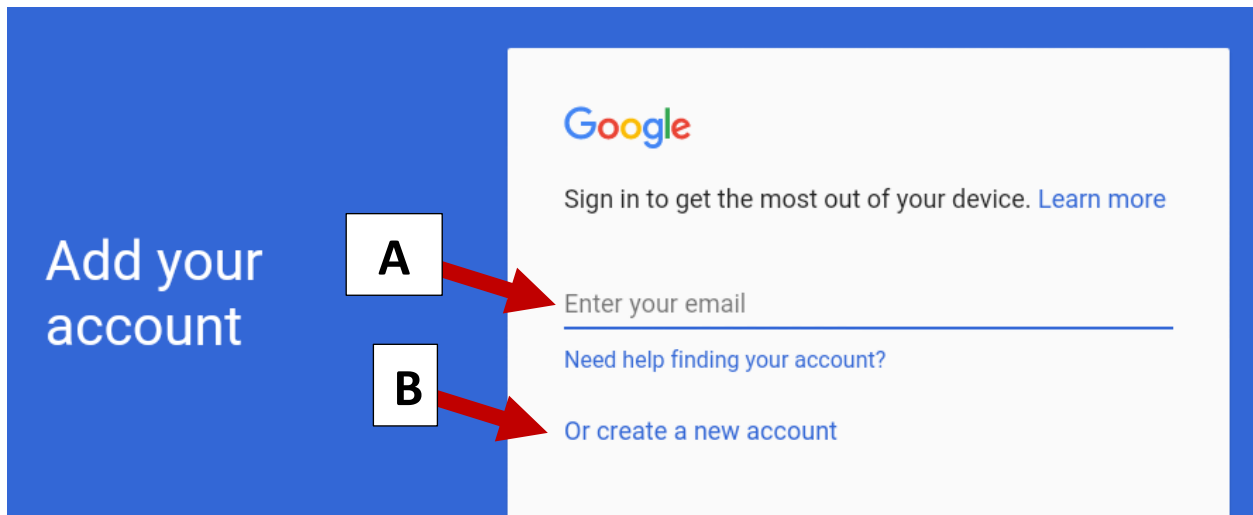

To sign in to an existing account, type in your Email address first, then type your Password.

Press Accept to continue.

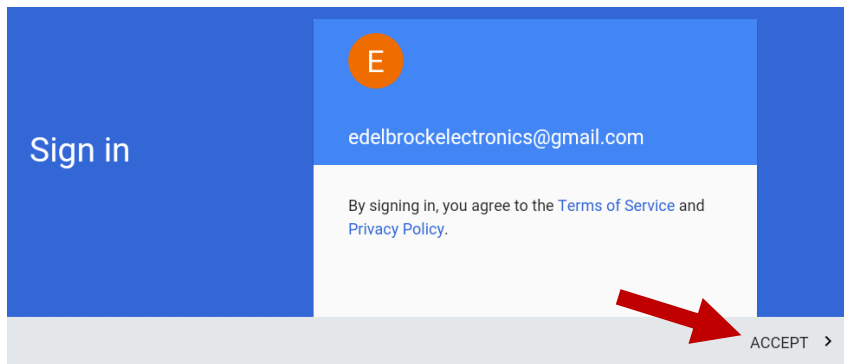

Press NEXT to continue:

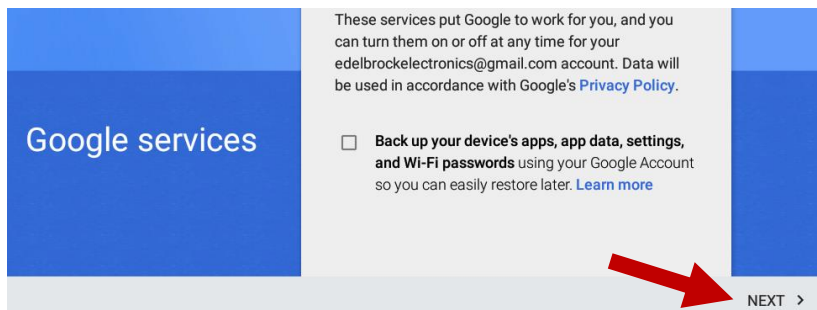

You should now see that a Google Account has been added to the Android Device:

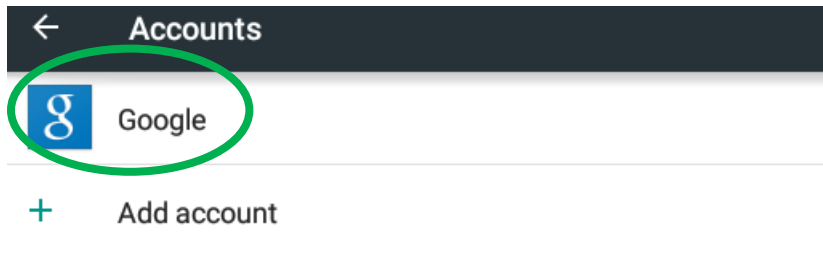

To Create a New Account, just follow the steps on the screen.

- You will need to enter a First & Last Name
- Create a name & password for the new email address.

Once a Google Account has been added, you can continue to update/install the app from the Play Store.